

product & accessory

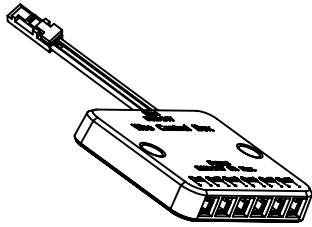

1\* wireless receiver

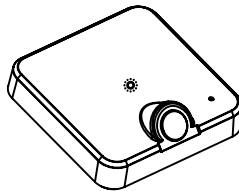

1\* wireless emitter of PIR sensor with touch dimmer



1\* screw



1\* magnet piece

A1

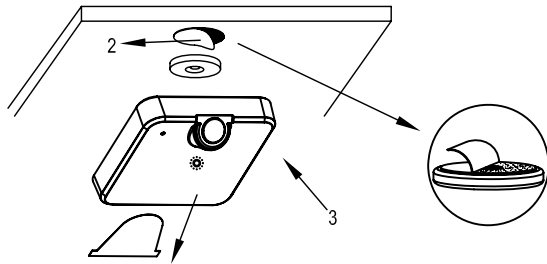

1. take off insulation sheet of battery
2. Fix the magnet piece onto the board with 3M tape
3. Stick the emitter onto the board with magnet piece

A2

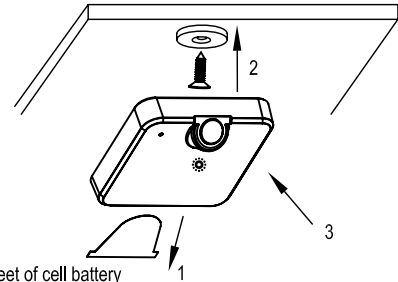

1. take off insulation sheet of cell battery
2. Fix the magnet piece onto the board
3. Stick the emitter onto the board with magnet piece

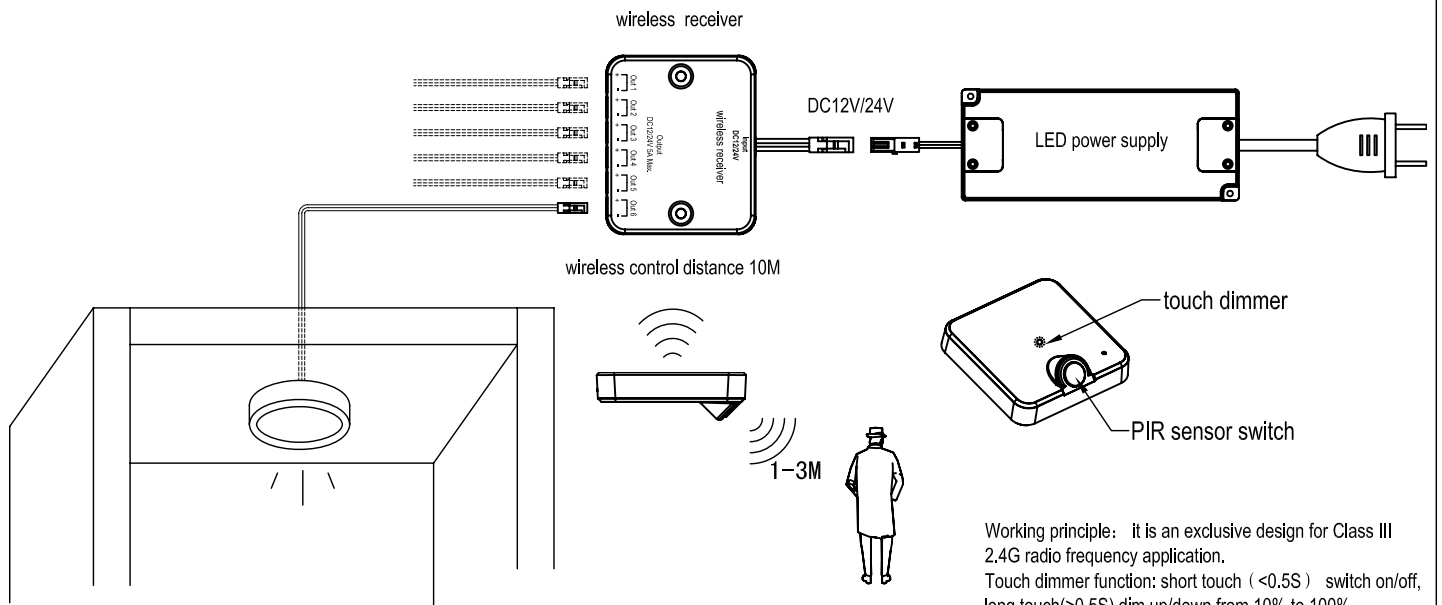

Working principle: it is an exclusive design for Class III 2.4G radio frequency application.  
 Touch dimmer function: short touch (<0.5S) switch on/off, long touch(>0.5S) dim up/down from 10% to 100% brightness steplessly.  
 PIR sensor switch on light when it detects human body movement within range 1-3M, switch off light when it detects human body leave with time delay 45S

pairing/unpairing

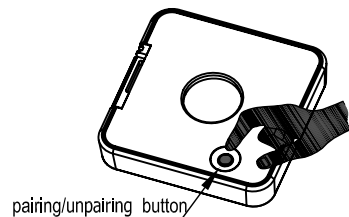

pairing/unpairing button

1. Pairing: Press the pairing button on the emitter within 3seconds after receiver connected to the power supply, it's successfully paired when the output light flash .
2. Unpairing: Long press(over3S) the pairing button on the emitter within 3seconds after receiver connected to the power supply, it's successfully unpaired when the output light flash .
3. One receiver can be paired with multiple emitters, one emitter can be paired with max. eight receivers. (one receiver and one emitter already paired in production, pls do the multiple pairing and unpairing by yourself.)

Battery change

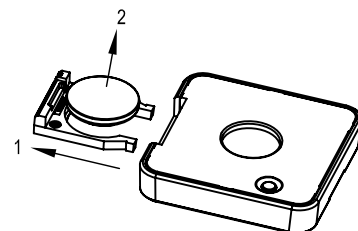

Indicating light quickly flashes when battery is low

1. Pull out the battery box
2. Change a new CR2032 cell battery