

DL2088 Single Colour LED COB Cabinet Downlight

 Voltage
12V/DC

 Power
3W

Recessed downlight with classic round design.

Features

- LED type: 1pc COB technology with high output
- Material: Aluminium, PC
- Finish/Colour: Silver, Black
- Cutout hole size 54mm
- Dimensions: 62mmØ x 10mmH
- CRI 80
- LED beam angle 120°
- Long life span LED light, more than 50,000 hours+
- Operating temperature: -20-50°C
- Switchable and/or dimmable by using single colour controller, sensor switch or Wi-Fi
- IP20, non-waterproof

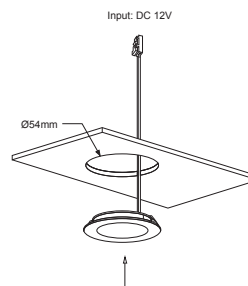
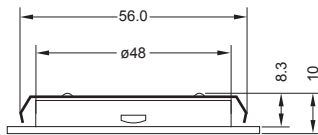
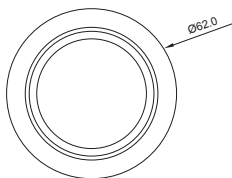

Code	Finish/Colour	Colour	Lumen/m	Cable Length
DL2088SR-CW-12V	Silver	Cool White 6500K	260	2M
DL2088SR-NW-12V	Silver	Natural White 4000K	220	
DL2088SR-WW-12V	Silver	Warm White 3000K	220	
DL2088BK-CW-12V	Black	Cool White 6500K	260	
DL2088BK-NW-12V	Black	Natural White 4000K	220	
DL2088BK-WW-12V	Black	Warm White 3000K	220	

Compatible Accessories

Power Supply (page 131-135)	12V-30W
	12V-60W
	Other specialist power supplies
Controller (page 115-124)	Single Colour Remotes
	Single Colour Touch Panels
	VP Controller (Remotes & Touch Panels)
	WT5 Controller (Wi-Fi & Voice Control)
Sensor Switch (page 127-130)	See Sensor Switch page for product details
Accessories (page 137-142)	See Accessories page for product details